

VERTICAL SIDING

WOOD SUBFRAME

Available panel size

5,35" x 96" | 137x2440mm

7,40" x 96" | 188 x 2440mm

11,42" x 96" | 290 x 2440mm

Panel thickness: 8mm

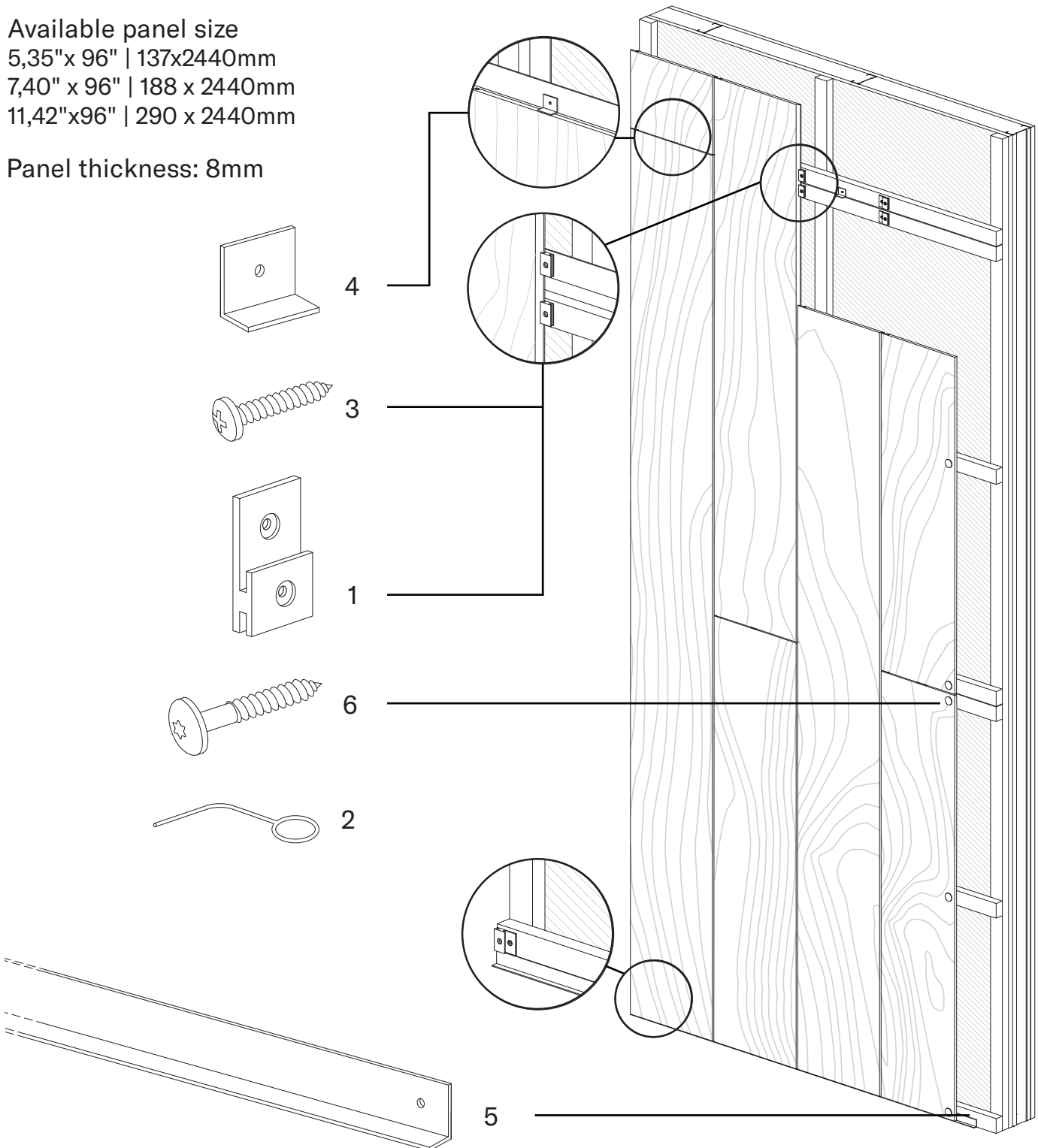

1. Fixing Clip

2. Gap Gauge Tool

3. Wood Screw for Fixing Clip DIN 7505

4. L 20x10 Black Stopper - Vertical Applications

5. L Profile Stopper 3.25m - Vertical Applications

6. TW-S D12-4 Screws for Wood - Painted