

**REMOVABLE CLIP SYSTEM
NATURPANEL-W, NATURHARDPANEL-W**

PARKLEX PRODEMA

How to install interior panels by using removable fastening with clips

NATURPANEL-W and NATURHARDPANEL-W panels can be installed by using clip system. This system is suitable for the installation of panels on walls and ceilings.

To use this installation system, the panel can have maximum dimensions of 2440 x 600 mm (96" x 24")

This installation system is removable and it can be installed on wood or a metallic subframe, and can be applied to interior walls and ceilings.

In the event that the wall is not perfectly plumb, wall brackets or shims are used to adjust the depth of the channel installation.

Panel thicknesses:

	8mm	10mm	11mm
NATURPANEL-W	✓		✓
NATURHARDPANEL-W	✓	✓	

Maximum panel dimensions:
2440 x 600 mm (96" x 24")

Panel layout:

	HORIZONTAL	VERTICAL
NATURPANEL-W	✓	✓
NATURHARDPANEL-W	✓	✓

Parklex Prodema supplies 2 types of clips: non-removable or removable.

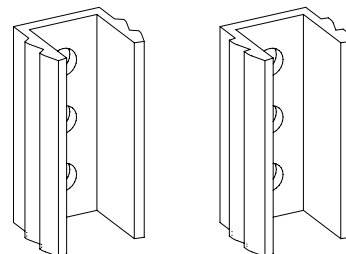

Non-removable clip:

Does not allow panels to be removed once fixed in their final position on the rails. When installing in ceilings, Parklex Prodema recommends the use of these clip in the entire installation except for the areas in which the pieces necessarily have to be removable.

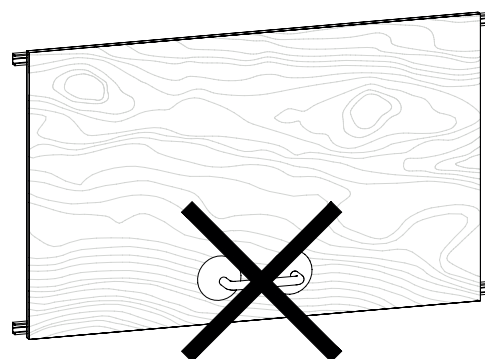

Removable clip:

Allows panel to be removed from the rails. The force required to remove them will depend on the panel size and number of used per piece. For more detailed information on the removal values, contact Parklex Prodema technical department.

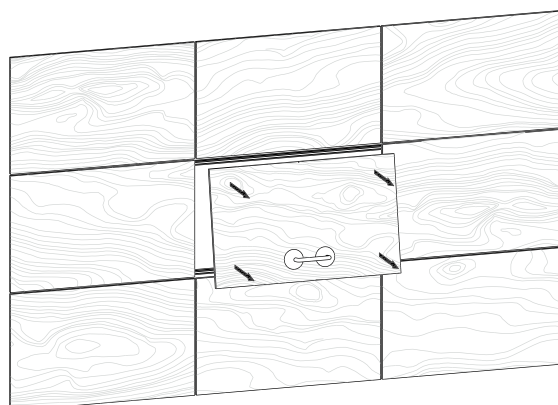

How to install interior panels by using removable fastening with clips

System Components:

Fixing

Removable clip

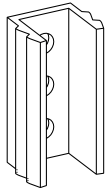

Non-removable clip

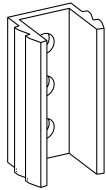

Stopper

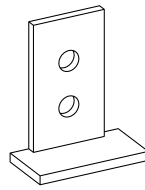

Marker

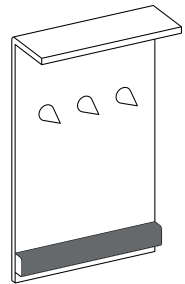

Single rail

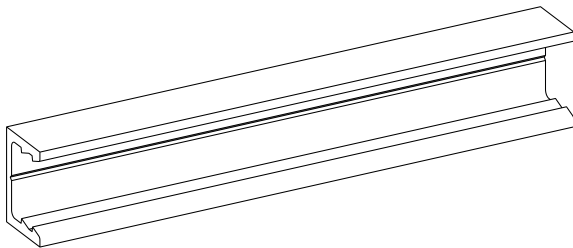

Milling screw



Joint rail

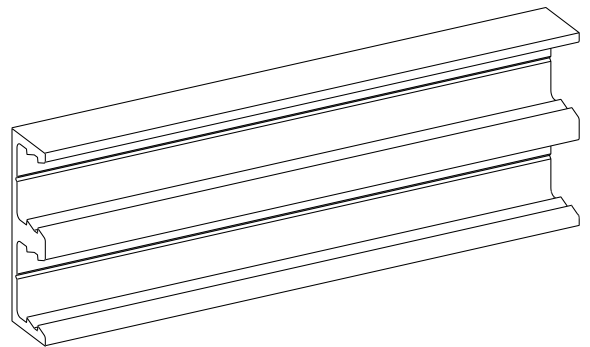

Recommended tools

Ø 3 mm drill

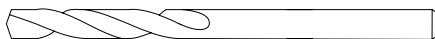

Spirit level

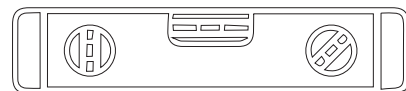

How to install interior panels by using removable fastening with clips

Clip direction.

The direction of the clips will depend on piece length direction.

Panels installed with length direction horizontal will require horizontally installed clips.

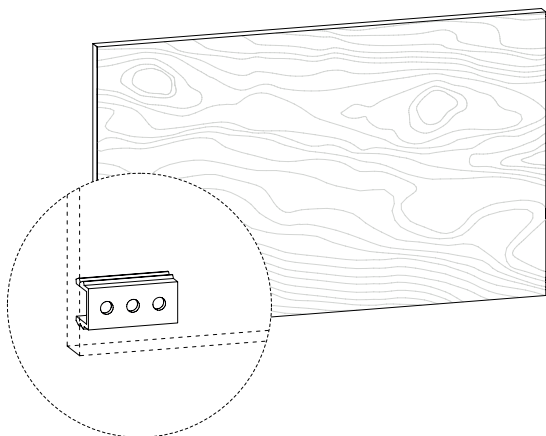

Clip placement.

The clips are fixed to the rear face of the panel using 3 milling screws per clip, as shown below.

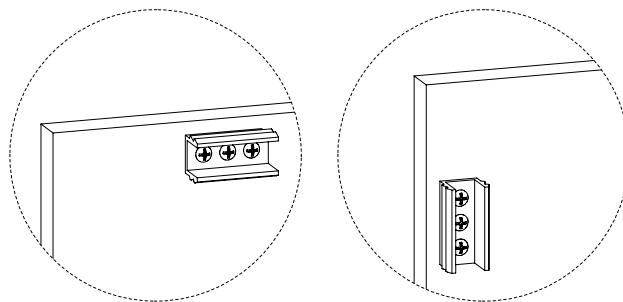

Panels installed with length direction vertical will require vertically installed clips.

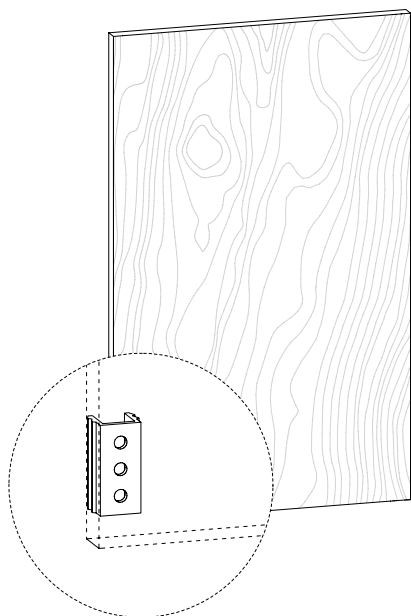

Each piece [maximum width 600mm (24")] must have 2 rows of clips installed parallel to the length of the piece.

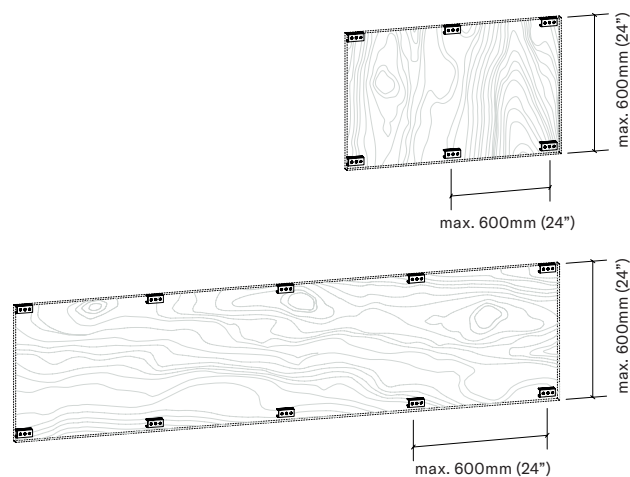

The maximum distance between clips, in the piece length grain direction, is 600mm (24").

How to install interior panels by using removable fastening with clips

Marking the panel.

Parklex Prodema supplies markers to guarantee that fasteners are perfectly aligned and at a specific distance from the panel edge. These are used to mark the place where the holes should be drilled in order to fix the clips to the rear of the panel.

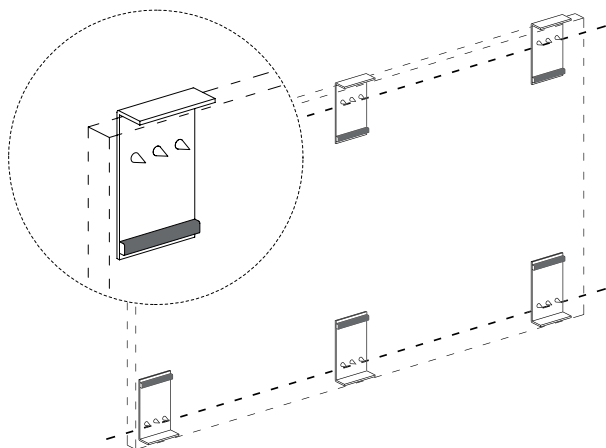

The distance from the clip to the panel edge must be as shown below.

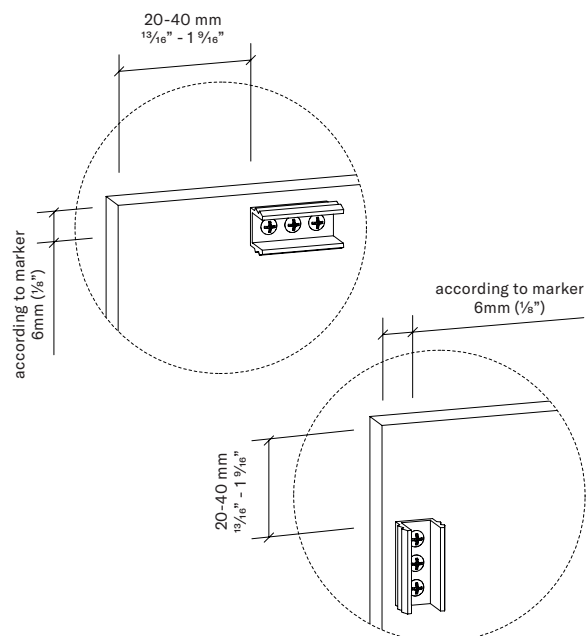

Fixing the clips.

The clips are fixed to the rear of the panel using milling screws ($\varnothing 3,5$ mm and 6,5 mm in length). To do so, first of all drill a hole $\varnothing 3$ mm and 6 mm in depth, slightly smaller than that of the screw, so that it will cut its own thread as it is screwed in place. This hole must be deeper than

the insertion length of the screw to permit accumulation of the shaving created when carving. However, a margin of at least 2mm ($1/16$ "") must be left with respect to the exposed side of the panel.

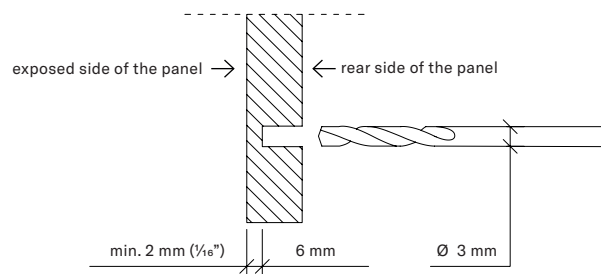

Types of rails.

Parklex Prodema supplies 2 types of rails.

Single rails:

Mainly for top or bottom panels. The fasteners fixed to the rear of the panel will slot into the carrier rails.

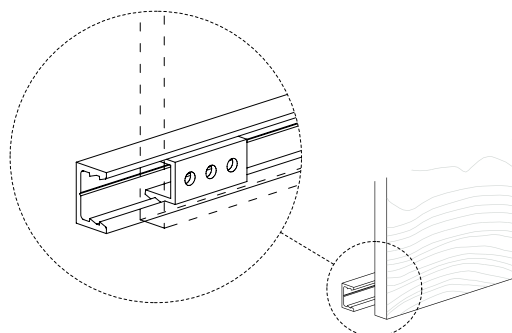

Joint rails:

For joints between two panels. The same clips hold in place the top of panel one and the bottom of panel 2.

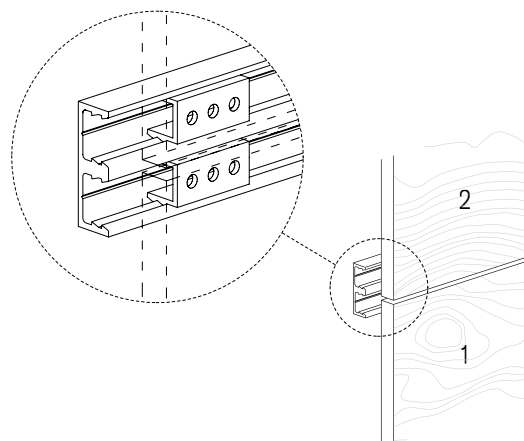

How to install interior panels by using removable fastening with clips

Removable clip system for walls.

1. Place the clips on the panel by using the marking tool. Follow the instruction on pages 5 and 6.

2. Install a single rail at the base, over the existing wall. It is extremely important that the first single rail at the base remains correctly aligned, as errors in the plumb / alignment will in turn affect the panels.

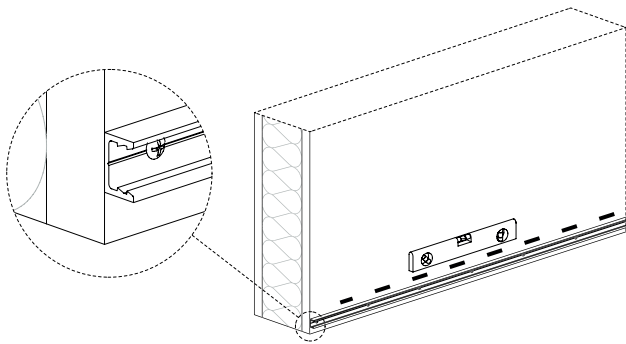

3. Slot the upper clips of the first panel into the lower part of a joint rail. Then, slot the lower clips of the panel into the previously installed single rail, as shown in the image.

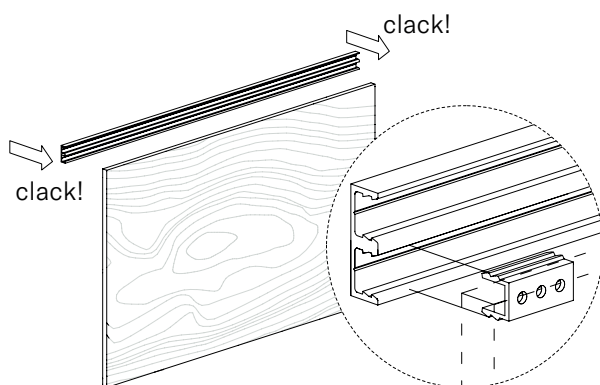

4. Fix the joint rail to the wall.

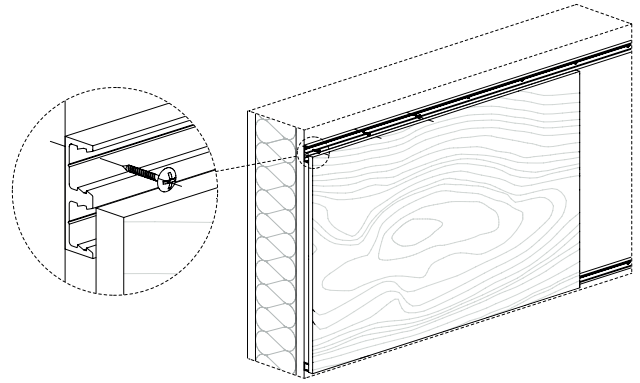

5. Slot the lower clips of the next panel with the upper part of the already-installed joint rail. The joint between panels will be of 3mm (1/8") when using the joint rail.

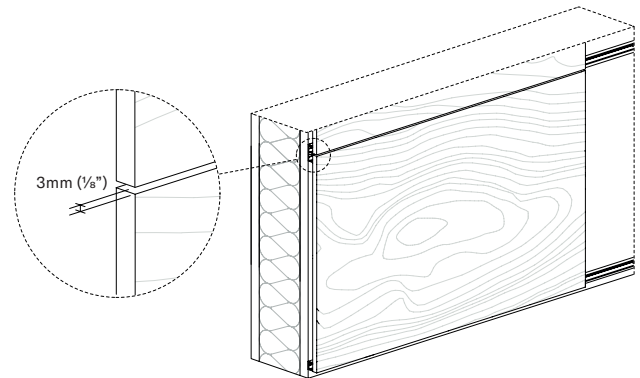

6. Install the termination single rail to the wall.

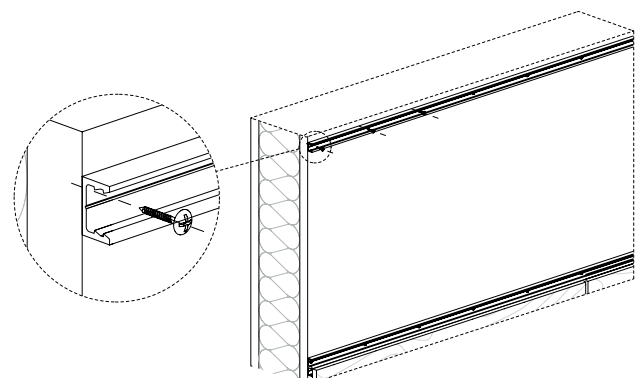

How to install interior panels by using removable fastening with clips

7.
Slot the last panel in.

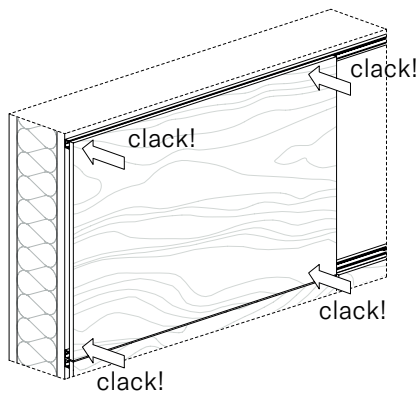

8.
This installation system allows the removal of any piece installed using a removable clip.

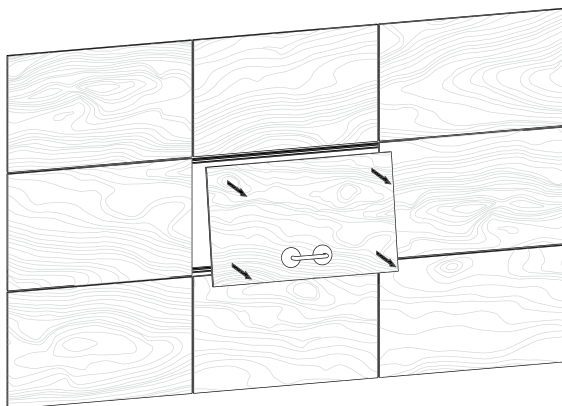

9.
If the rails are installed vertically, a stopper must be fixed to the wall in order to hold the base of each panel to prevent vertical movement along the rail.

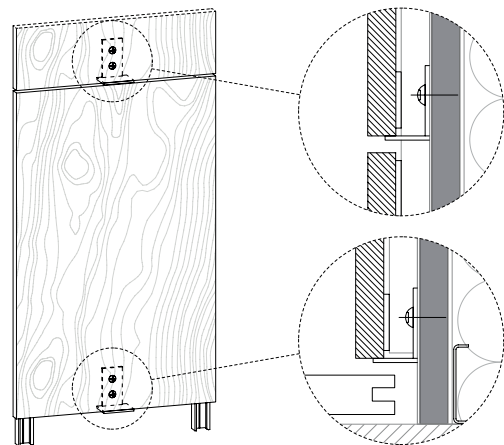

How to install interior panels by using removable fastening with clips

Removable clip system for ceilings.

When installing in ceilings, Parklex Prodema recommends the use of non-removable clips in the entire installation, except for the areas in which the pieces necessarily have to be removable.

1.
Place the clips on the panel by using the marker tool.
Follow the instruction on pages 5 and 6.

2.
Install wooden or metallic profiles in the places in which the rails will be placed.

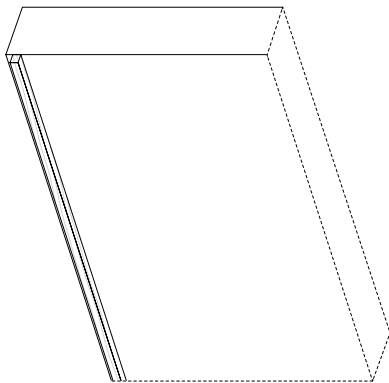

3.
Install a first single rail over a previously installed profile, as shown in the image. It is extremely important that the first single rail remains correctly aligned, as errors in the plumb/alignment will in turn affect the panels.

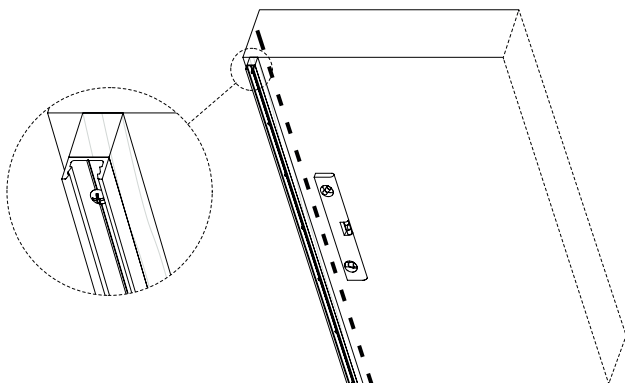

4.
Slot the right row of clips of the first panel into a joint rail.

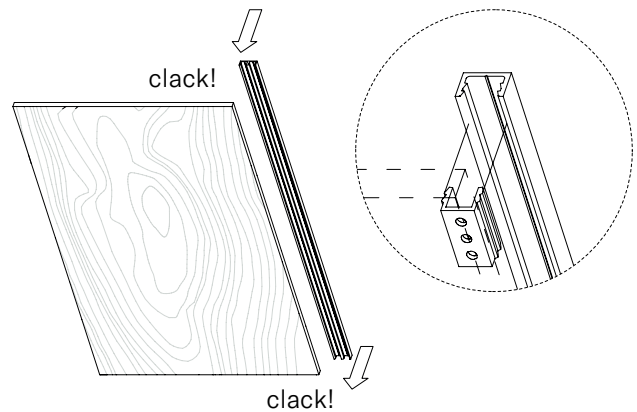

5.
Slot the left row of clips into the previously installed first single rail, as shown in the image.

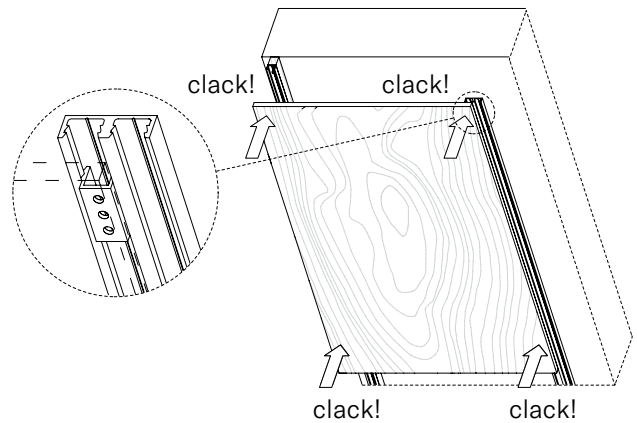

6.
Fix the joint rail over the pre-installed profile.

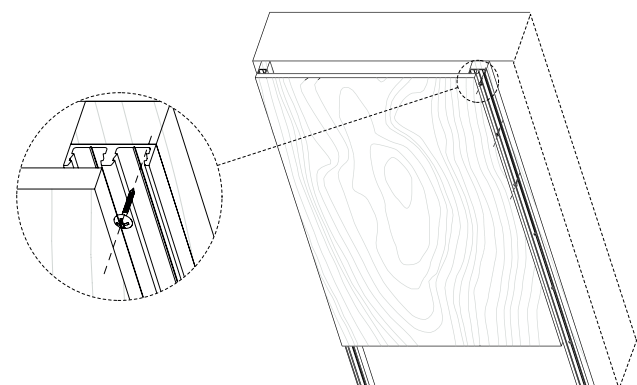

How to install interior panels by using removable fastening with clips

7.

Repeat step 3 with the next panel, and slot the left row of clips into the previously installed joint rail. The joint between panels will be of 3mm ($\frac{1}{8}$ ") when using the joint rail.

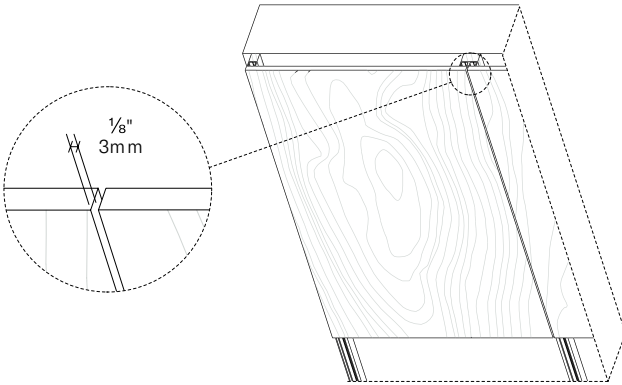

9.

Slot the last panel in.

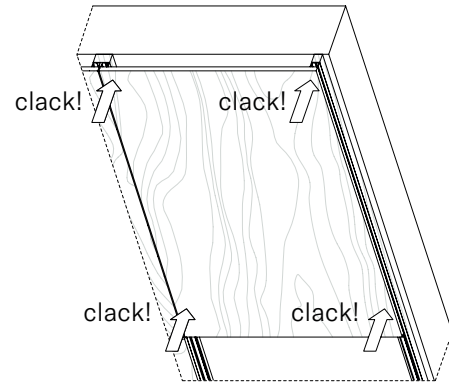

8.

Install the termination single rail over the preinstalled profile.

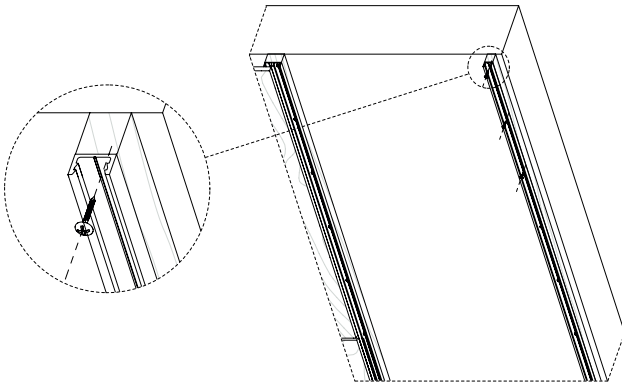

10.

This installation system allows the removal of any piece installed using a removable clip.

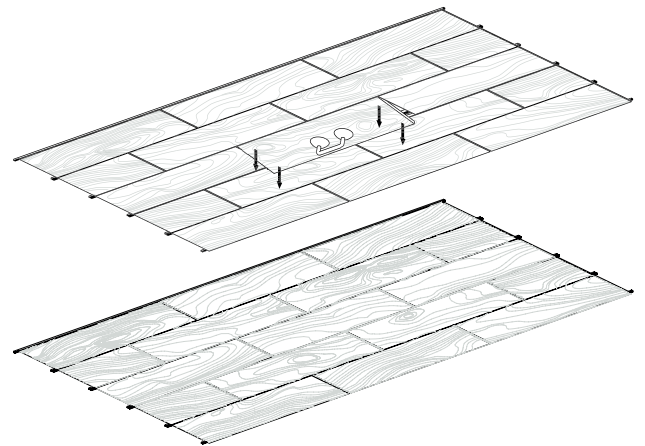

How to install interior panels by using removable fastening with clips

Installation details:

PARKLEX PRODEMA has an extensive range of solutions showing all types of installation details to address corners, windows, crowns, etc. All of these details are available on the Technical Area of the PARKLEX PRODEMA website.

WALL BASE

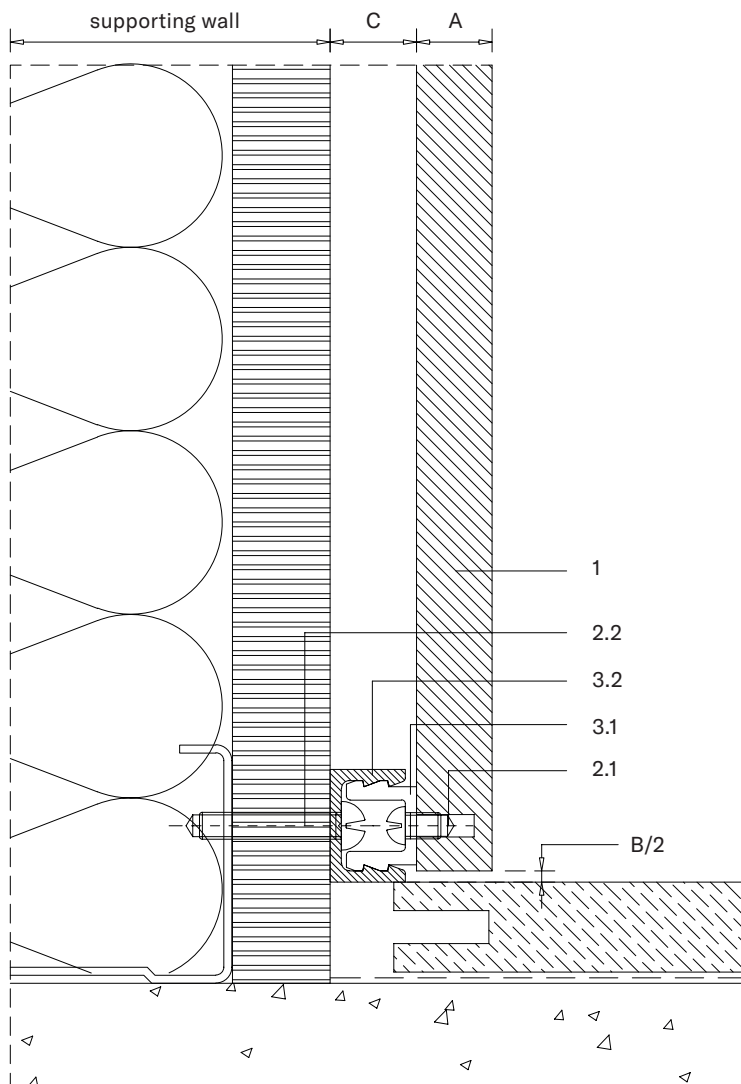

HORIZONTAL JOINT

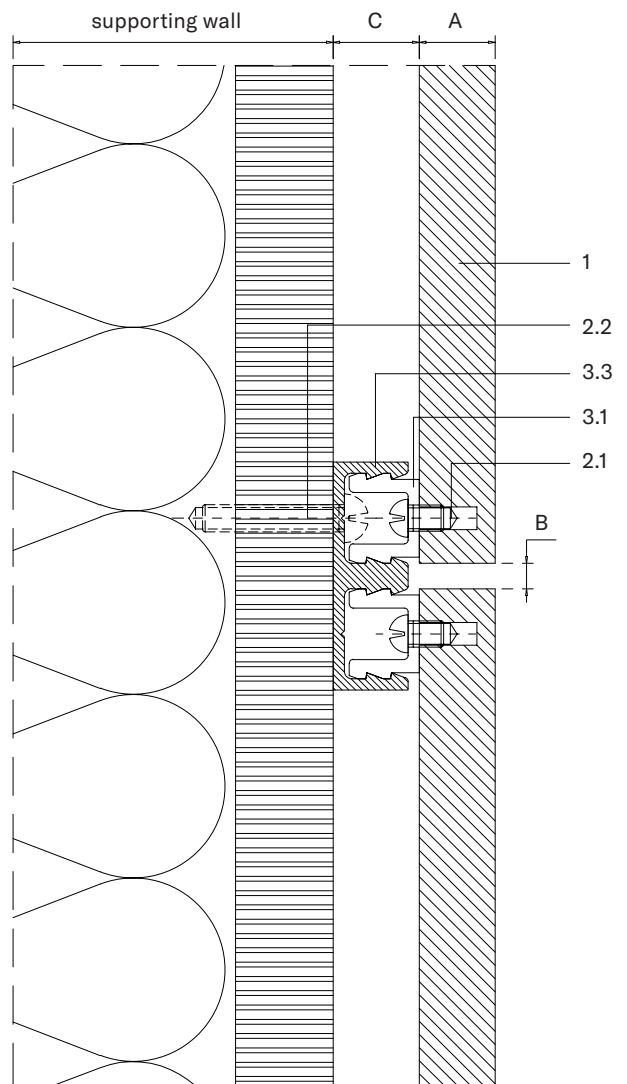

- 1. NATURHARDPANEL-W
- 2. Screws
 - 2.1. Fixing screw
 - 2.2. Wall fixing screw /by others
- 3. Profiles
 - 3.1. Removable / non removable clip
 - 3.2. Single rail
 - 3.3. Joint rail
- A. Panel thickness 8-12 mm ($\frac{5}{16}$ "- $\frac{1}{2}$ ")
- B. Expansion joint 3 mm ($\frac{1}{8}$ ")
- C. Chamber depth 10 mm ($\frac{3}{8}$ ")

How to install interior panels by using removable fastening with clips

VERTICAL JOINT

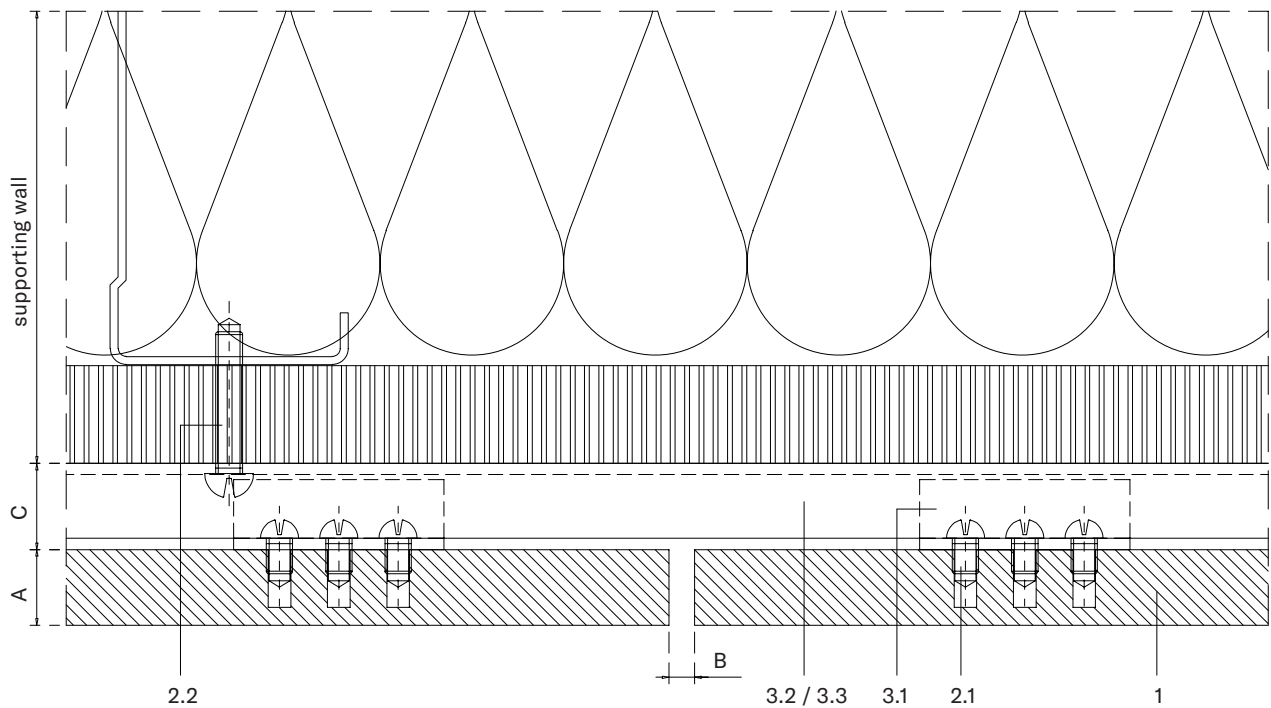

INTERIOR CORNER

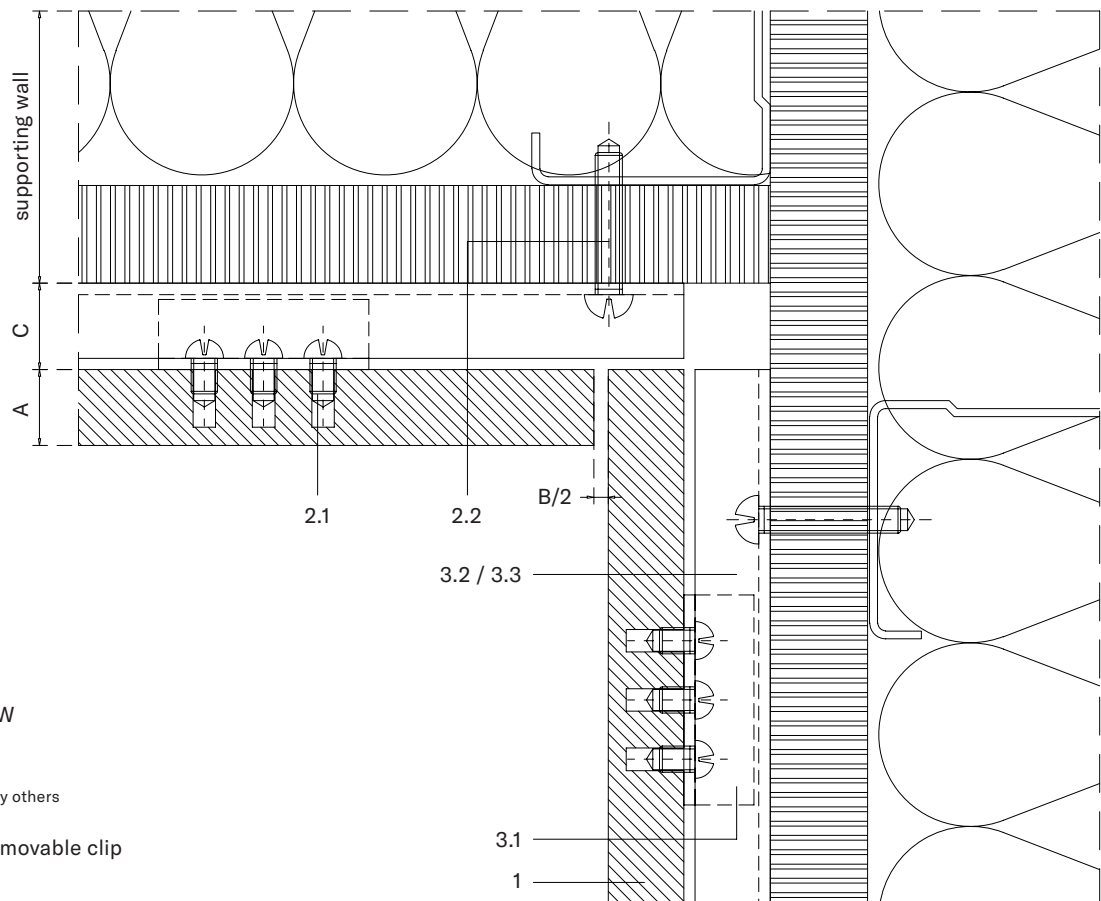

1. NATURHARDPANEL-W

2. Screws

2.1. Fixing screw

2.2. Wall fixing screw /by others

3. Profiles

3.1. Removable / non removable clip

3.2. Single rail

3.3. Joint rail

A. Panel thickness 8-12 mm ($\frac{5}{16}$ " - $\frac{1}{2}$ ")B. Expansion joint 3 mm ($\frac{1}{8}$ ")C. Chamber depth 10 mm ($\frac{3}{8}$ ")

How to install interior panels by using removable fastening with clips

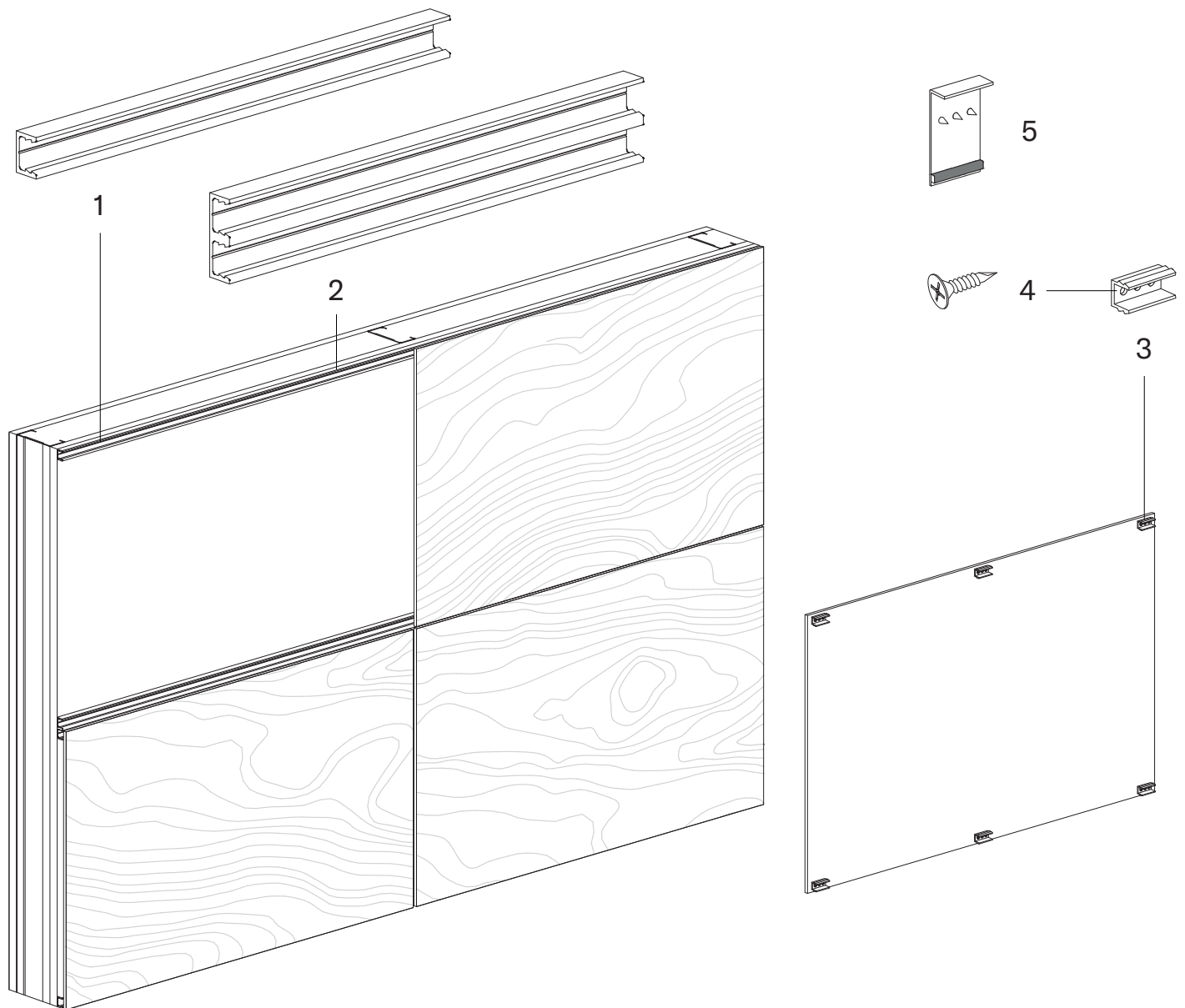

REMOVABLE CLIP SYSTEM FOR WALLS AND CEILINGS HORIZONTAL LAYOUT

1. Single Profile 10' length
2. Joint Profile 10' length
3. Clips (two options): Removable Clip | Non-Removable Clip
4. Panel Screw 3.5 x 6.5 mm
5. Marker for Screw Position

Available panel size
96" x 24" | 2440 x 600mm

Panel thickness $\geq 8\text{mm}$

How to install interior panels by using removable fastening with clips

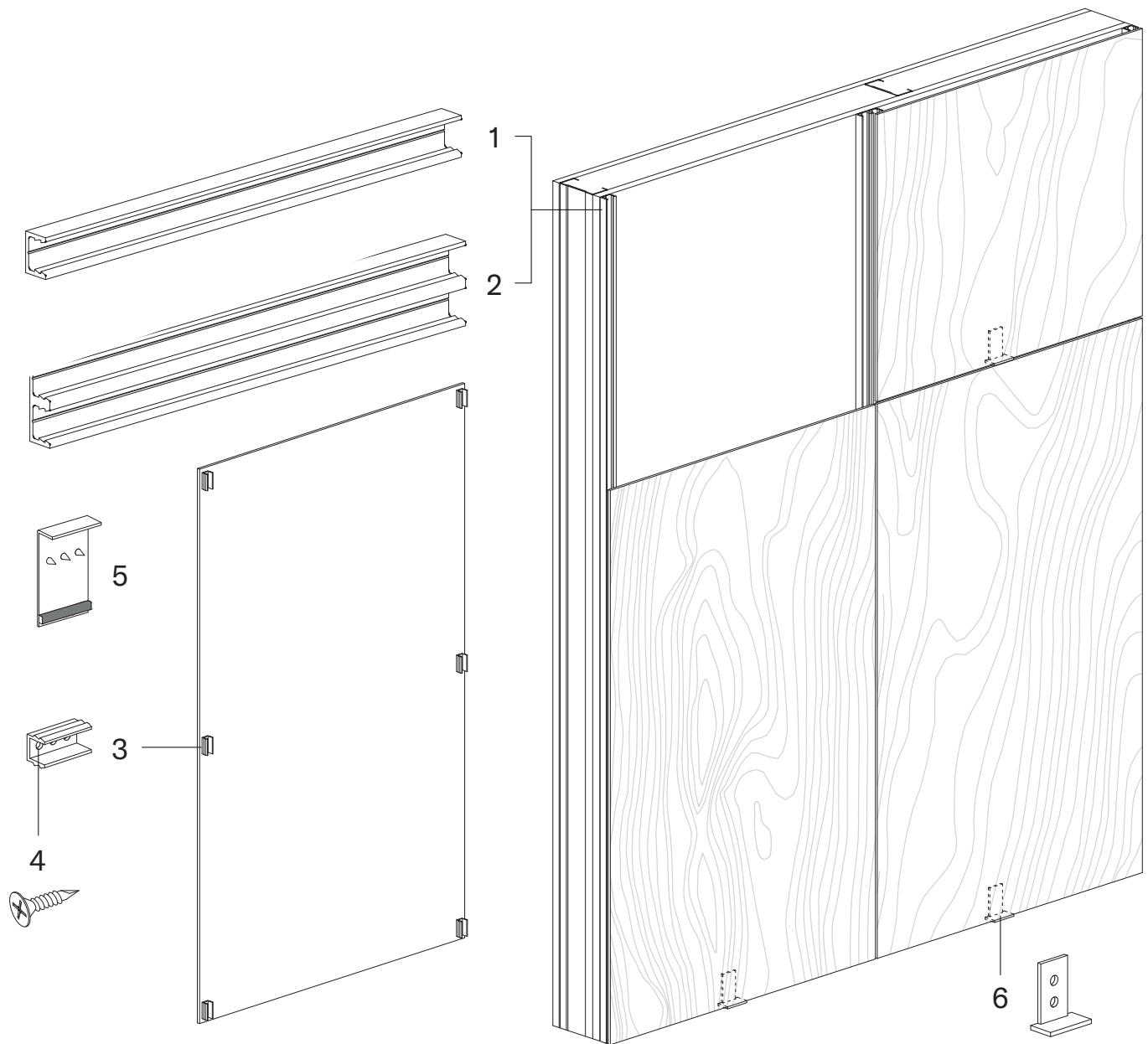

REMOVABLE CLIP SYSTEM FOR WALLS AND CEILINGS VERTICAL LAYOUT

1. Single Profile 10' length
2. Joint Profile 10' length
3. Clips (two options): Removable Clip | Non-Removable Clip
4. Panel Screw 3.5 x 6.5 mm
5. Marker for Screw Position
6. Stopper for VERTICAL panel installation

Available panel size
96" x 24" | 2440 x 600mm

Panel thickness \geq 8mm

